

**CITY OF DUNDEE  
PARKS ADVISORY COMMITTEE MEETING**

**Fire Station Community Meeting Room**

**801 N. Highway 99W**

**Dundee, OR 97115**

**THIS MEETING WILL ALSO BE TELECONFERENCED ON ZOOM  
MEETING I.D.: 861 6966 1573**

---

**February 5, 2025**

**7:00 P.M.**

---

- 1. Call to Order**
- 2. Public Comments**
- 3. Business Items**
  - 3.1 tipsu palach Park – Picnic Shelter**
  - 3.2 tipsu palach Park – Picnic Tables**
  - 3.3 tipsu palach Park – Size of the shelter**
  - 3.4 tipsu palach Park – Proposal for water feature**
  - 3.5 Update on Sander Estate Park**
- 4. Committee Concerns**
- 5. Adjournment**

The Fire Station Community Meeting Room is accessible to persons with disabilities. A request for an interpreter for the hearing impaired, or for other accommodations for persons with disabilities, should be made at least 48 hours in advance of the meeting to Steve Dahl, City Administrator at 503-538-3922.

# AGENDA REPORT

**To:** Parks Committee  
**From:** Steve Dahl, City Administrator  
**Date:** February 5, 2025  
**Reason:** tipsu palach Park

---

## **Background:**

### **Shelter**

Last year, the Parks Advisory Committee recommended that the city purchase two picnic tables from Columbia Cascade Company to fit under the shelter. Additionally, the committee advised against pursuing the leaf shelter concept and instead recommended a slant structure from Western Wood Structures, an Oregon-based company. I would like to confirm that the committee remains comfortable with these decisions.

I propose that the city use colored concrete to match the rocks planned for the base of the shelter.

What size does the committee want to make the structure?

We can also do matching structures over the two park benches.

### **Water Feature**

I recommend that the city hire Dan Jensen, the park architect who designed tipsu palach Park, to design the water feature. The design has been included in the packet for review. Is the committee in agreement with this recommendation? If so, I will present it to the council on February 18<sup>th</sup> to initiate a request for proposals for a contractor to build the water feature.

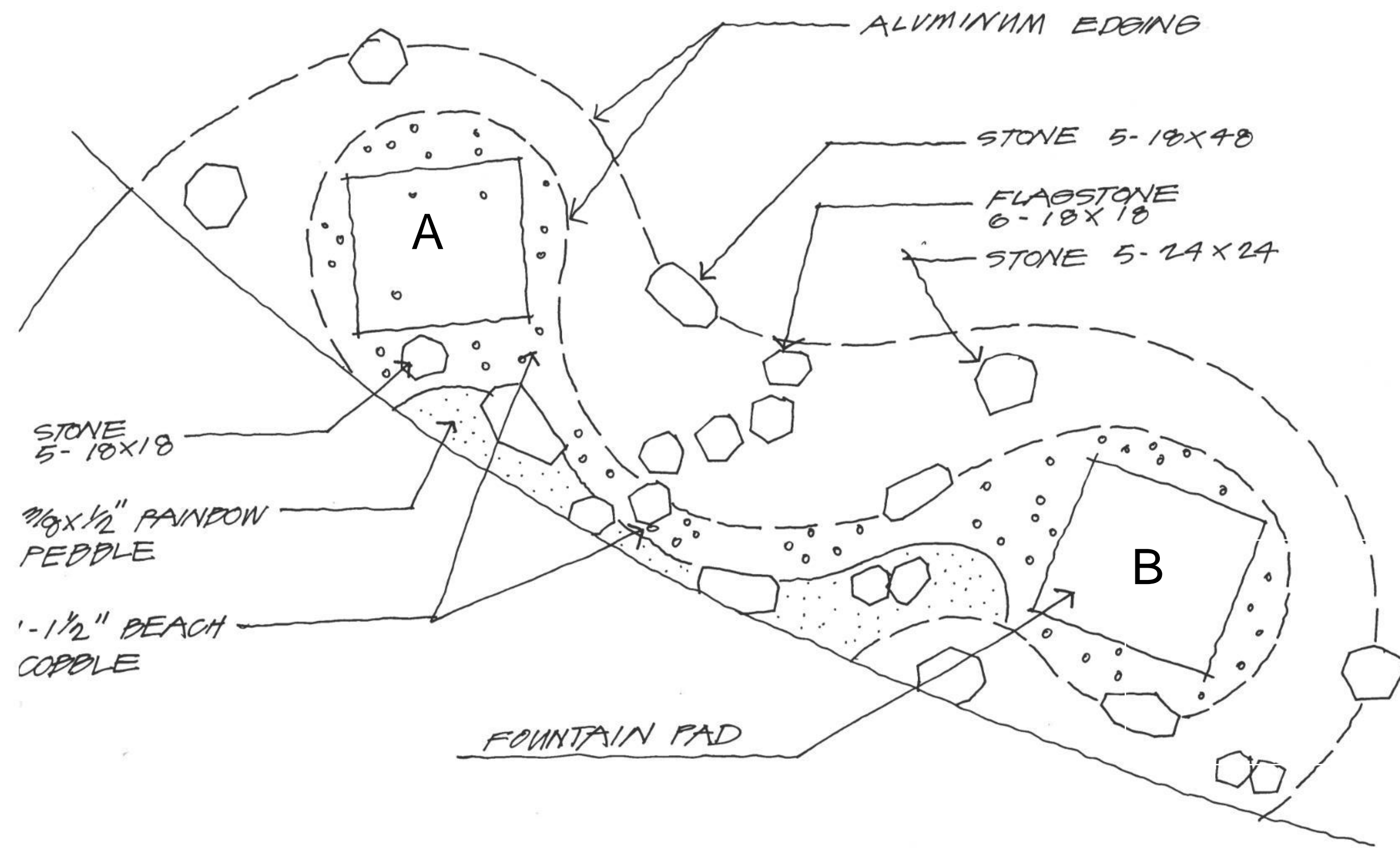

**MATERIAL SCHEDULE:**

ITEM	PRODUCT	SOURCE	SIZE
BOULDERS	BRONZE COLUMNS	VALLEY LANDSCAPE CENTER	AS NOTED ON PLANS
COBBLE	BEACH COBBLE	VALLEY LANDSCAPE CENTER	1 TO 1-1/2 INCH
PEBBLE	RAINBOW PEBBLE	VALLEY LANDSCAPE CENTER	3/8 TO 1/2 INCH
FLAGSTONE	GOLD QUARTZITE	VALLEY LANDSCAPE CENTER	2 INCH THICK
ALUMINUM EDGING	CLEANLINE XL	PERMALOC EDGING	3/16 X 6 INCH
BARK MULCH	FRESH MEDIUM FIR	VALLEY LANDSCAPE CENTER	2 INCH DEPTH

**SITWORKS NOTES**

1. ALL LAYOUT SHALL BE APPROVED PRIOR TO COMMENCEMENT OF CONSTRUCTION.
2. ALL SOIL COMPACTION AND PREPARATION SHALL BE APPROVED BY OWNER
3. ALL MATERIALS SHALL BE REVIEWED AN APPROVED BY OWNER PRIOR TO INSTALLATION
4. BOULDER MATERIAL IS INTENDED FOR PRICING ONLY. FINAL SELECTION WILL BE APPROVED BY OWNER PRIOR TO INSTALLATION

**1 SITWORKS PLAN**

SCALE 1/4" = 1'-0"

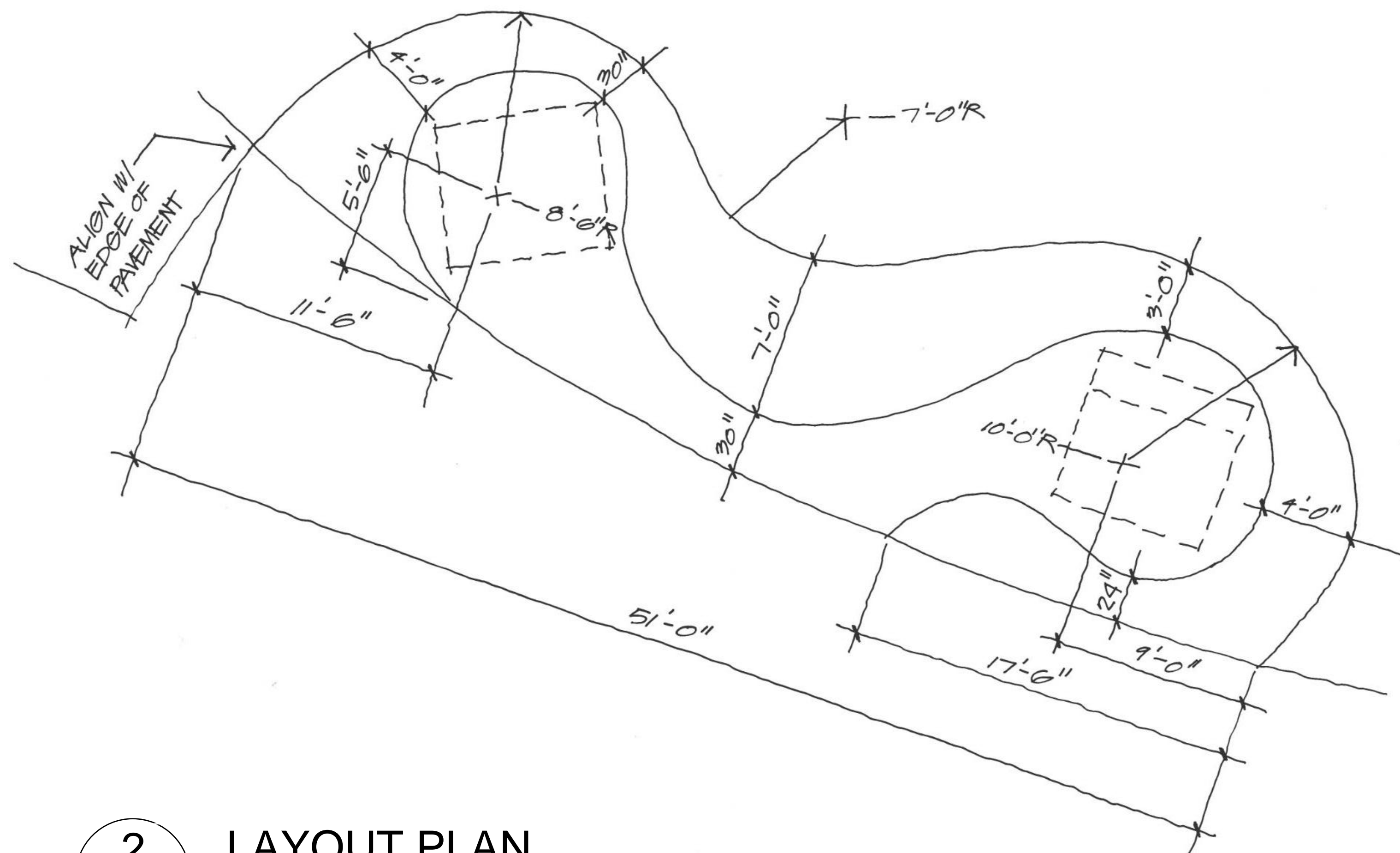

**2 LAYOUT PLAN**

SCALE 1/4" = 1'-0"

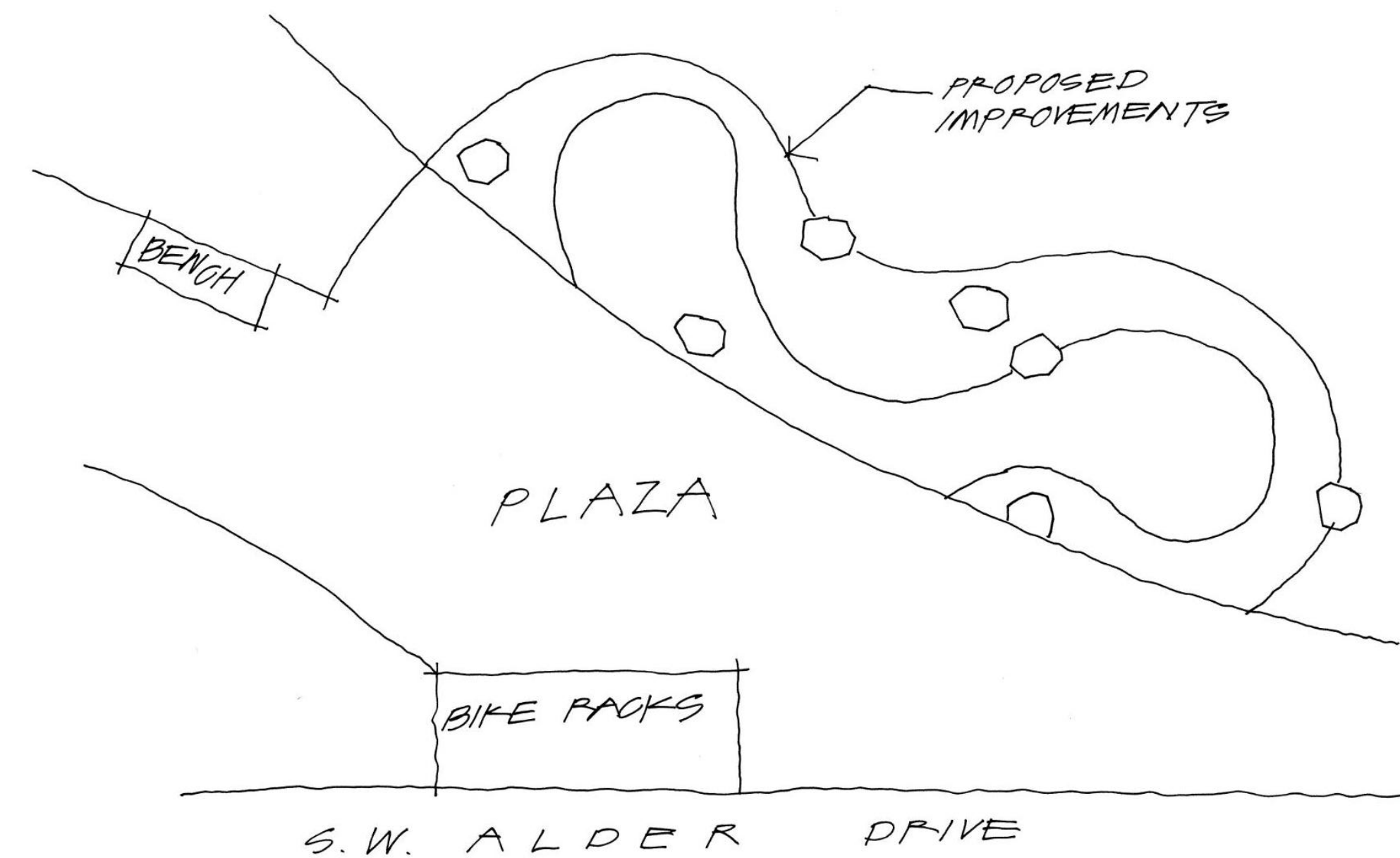

**3 SITE LOCATION PLAN**

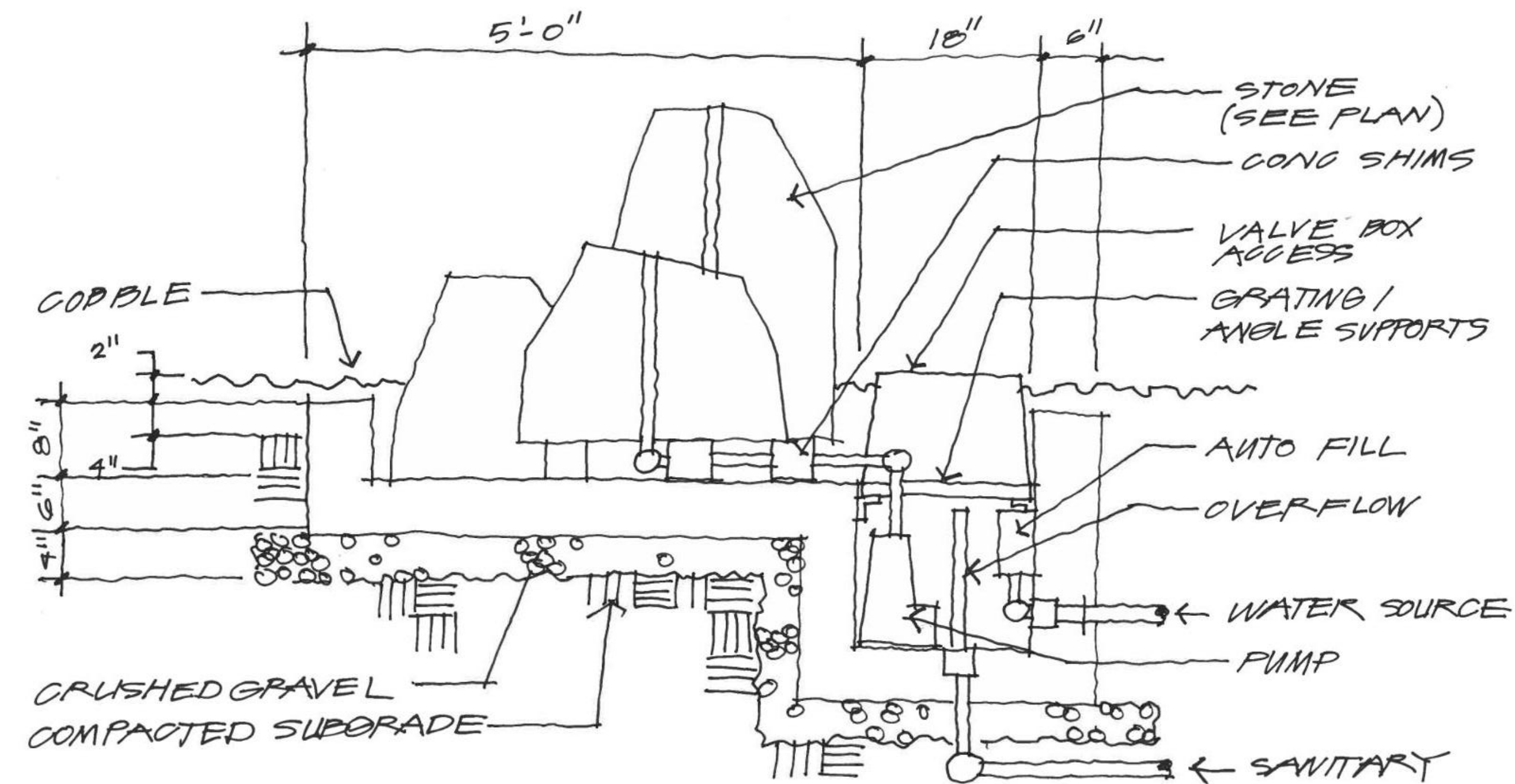
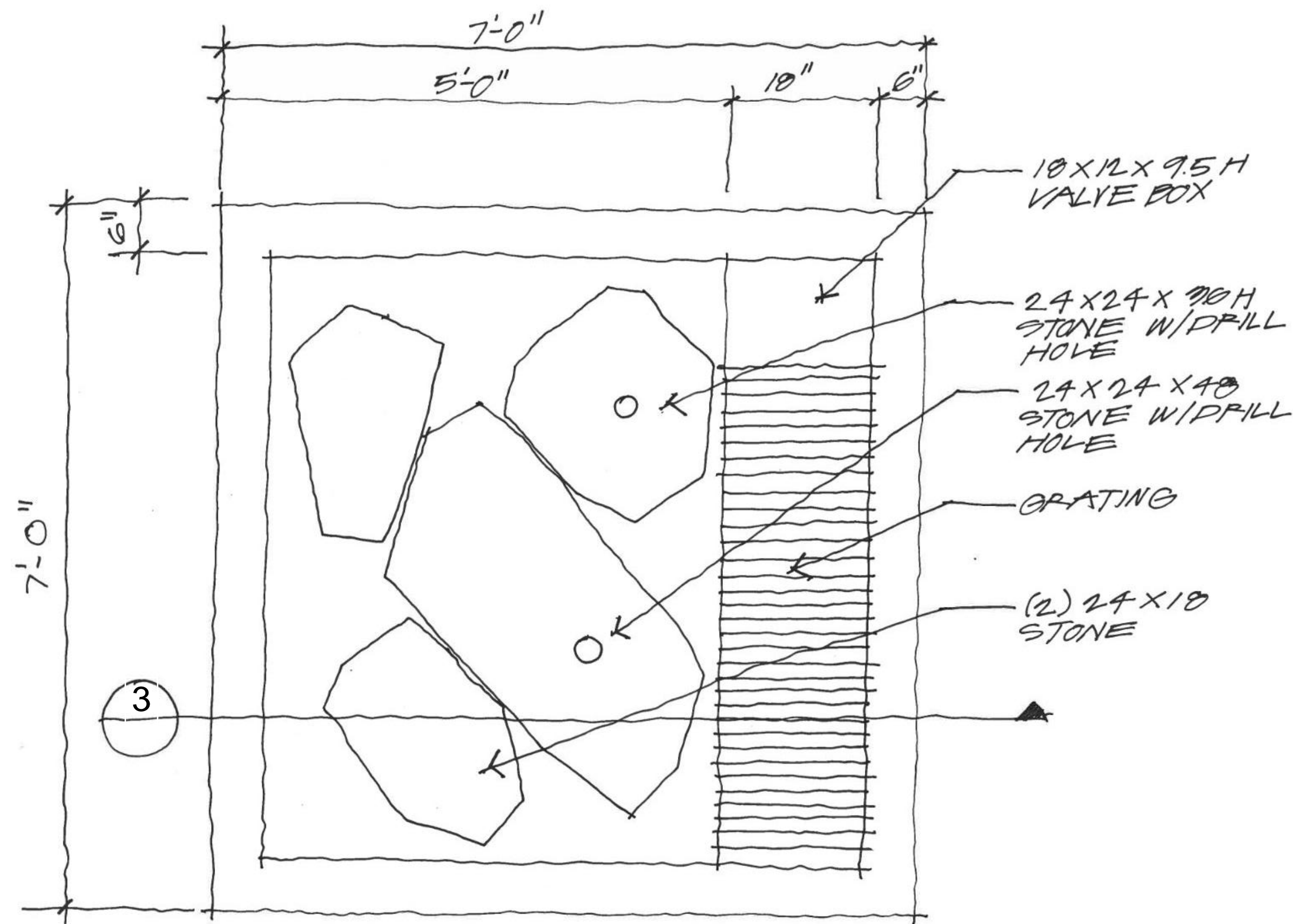

1 FOUNTAIN PLAN -A  
SCALE 1" = 1'-0"

3 FOUNTAIN SECTION  
SCALE 1" = 1'-0"

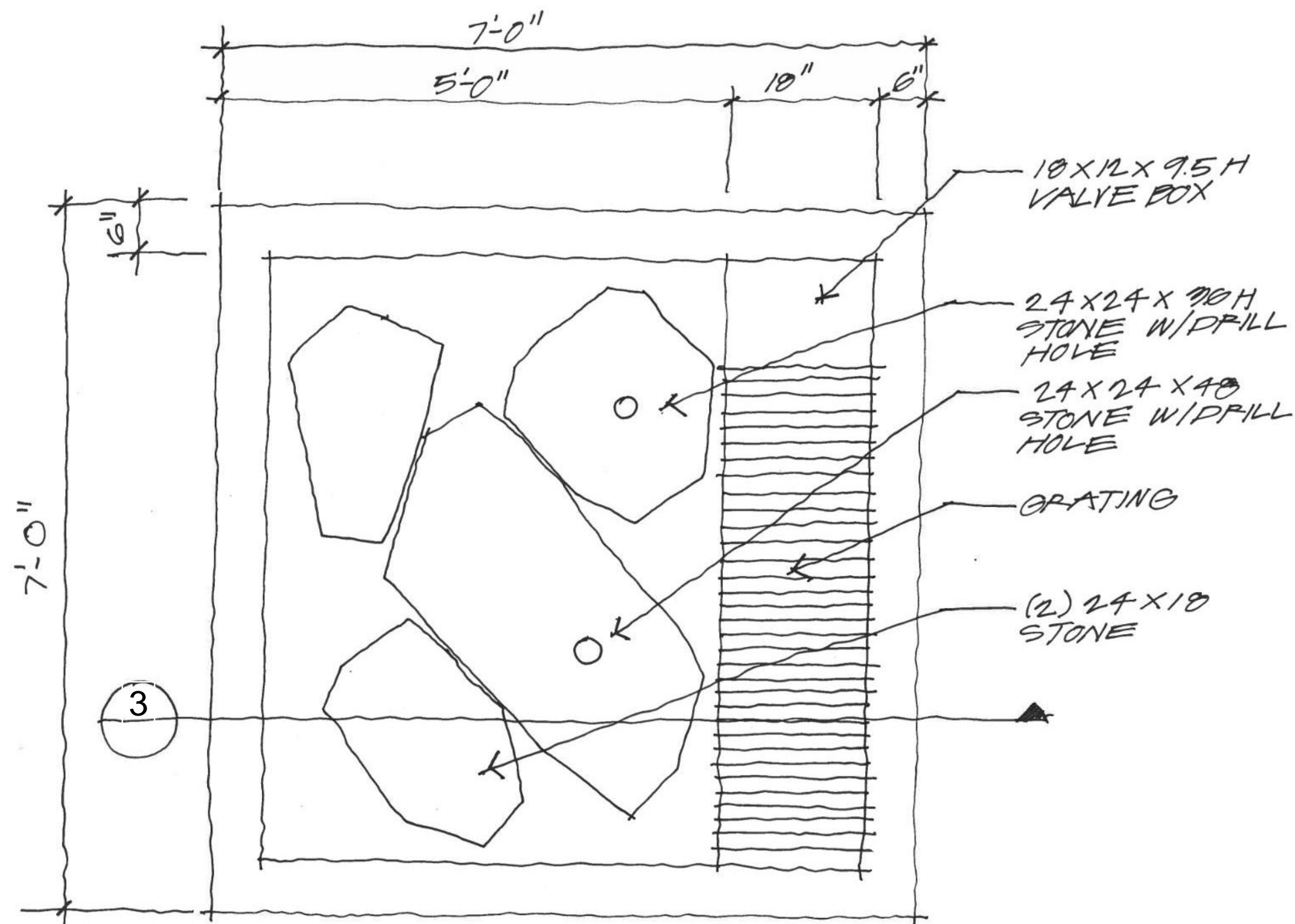

2 FOUNTAIN PLAN -B  
SCALE 1" = 1'-0"

### CONSTRUCTION NOTES

1. ALL CONCRETE SLAB AND CURBS SHALL RECEIVE #4 REBAR
2. CONCRETE FOUNTAIN SLABS SHALL RECEIVE WATERPROOF MEMBRANE
3. DETAILS ARE CONCEPTUAL FOR PRICING ONLY - CONTRACTOR SHALL PROPOSE AND SUBMIT DESIGN/BUILD DRAWINGS FOR OWNER REVIEW
4. CONTRACTOR SHALL SUBMIT ALL FOUNTAIN MATERIALS FOR OWNER REVIEW AND APPROVAL PRIOR TO INSTALLATION
5. CONTRACTOR SHALL SUBMIT OPERATIONS AND MAINTENANCE MANUAL TO OWNER.
6. CONTRACTOR SHALL GUARANTEE FOUNTAIN FOR A ONE YEAR PERIOD AND MAINTAN FOR A 3-MONTH PERIOD AFTER SUBSTANTIAL COMPLETION

CITY OF DUNDEE  
TIPSU PALACH PARK  
WATER FEATURE

REVISIONS

ISSUE DATE:  
REVIEW: 12/19/2024

CONSTRUCTION  
DETAILS

L - 2.0

**PLANTING NOTES**

1. ALL PLANTING AREAS NOT COVERED BY COBBLE OR PEBBLE SHALL RECIEVE A 2-INCH LAYER OF BARK MULCH
2. ALL PLANTING SHALL RECIEVE DRIP IRRIGATION CONTROLLED BY A NEW SEPARATE IRRIGATION VALVE CONNECTED TO THE EXISTING CONTROLLER AND POINT OF CONNECTION
3. ALL PLANT MATERIAL SHALL BE REVIEWED AND APPROVED BY OWNER PRIOR TO PLANTING
4. ALL PLANTING AREAS SHALL BE AMENDED WITH ORGANIC COMPOST AT A RATE OF 4 YARDS PER 1000 SQUARE FEET
5. ALL PLANTING SHALL BE FERTILIZED AS RECOMMENDED IN AN AGRICULTURAL SOILS TEST
6. ALL PLANT MATERIAL SHALL BE MAINTANIED AND GUARANTEED FOR A 3 MONTH PERIOD

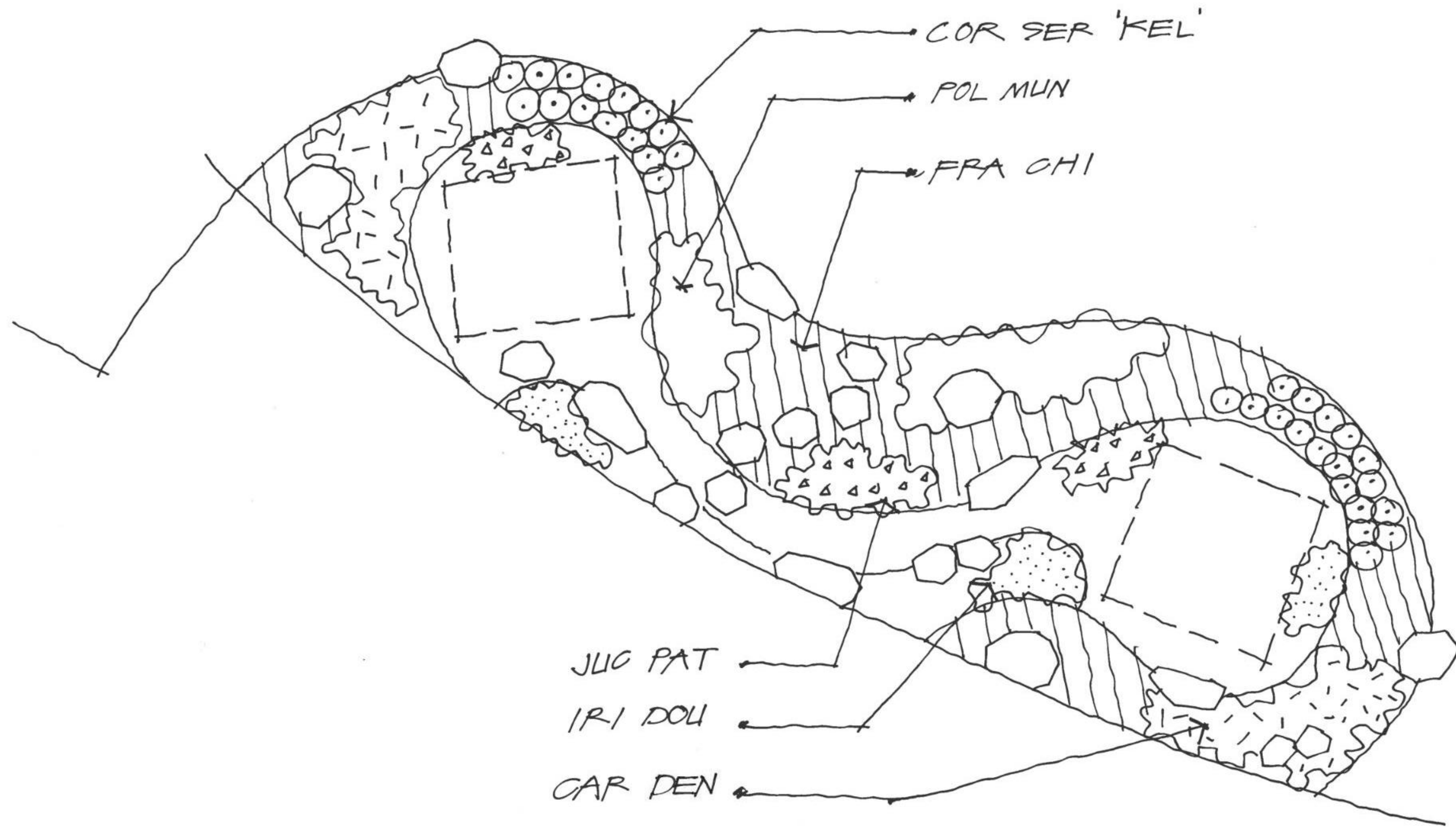

**1** **PLANTING PLAN**  
SCALE 1/4" = 1'-0"

**PLANTING SCHEDULE**

SYMBOL	BOTANICAL NAME	COMMON NAME	SIZE	NOTES
CAR DEN	CAREX Densa	DENSE SEDGE	1 GALLON	18 INCHES ON-CENTER
COR SER 'KEL'	CORNUS SERICEA 'KELSEYI'	REDTWIG DOGWOOD	2 GALLON	AS SHOWN
FRA CHI	FRAGERIA CHILOENSIS	BEACH STRAWBERRY	4 INCH POTS	12 INCHES ON-CENTER
IRI DOU	IRIIS DOUGLASIANA	DOUGLAS IRIS	1 GALLON	18 INCHES ON-CENTER
JUN PAT	JUNCUS PATENS	SPREADING RUSH	1 GALLON	18 INCHES ON-CENTER
POL MUN	POLYSTICHUM MUNITUM	SWORD FERN	3 GALLON	24 INCHES ON-CENTER





# Columbia Cascade Company

Makers of TimberForm® PipeLine® Playground Equipment and Outdoor Fitness Systems, TimberForm Site Furniture and CycLoops® CycLocker® Bicycle Management Products.

PO Box 1039  
Camas, WA 98607-0039 U.S.A.  
Telephone 503/223-1157  
e-mail HQ@timberform.com

Steve.dahl@dundeecity.org

Date: Dec 15, 2023

Pages: 1 of 1

To: City of Dundee  
Attn: Mr. Steve Dahl  
Reference: Tpsu Palach Park (Formerly Alder Park)  
Dundee, OR  
Quote No. Q-23-98491-A1

Thank you for your interest in TimberForm Site Furniture products. We are pleased to offer our quotation for the above-referenced project as follows:

### TIMBERFORM

<u>Quantity</u>	<u>Model No. and Description</u>
2 each	2167-6-P GREENWAY Accessible Picnic Table with Seats, BLACK CASPAX-7 powder-coated steel frames, Cedar colored recycled plastic slats, mounting selection to be specified at time of order entry. Specify (-E) embedment or (-P) pedestal mount.

---

**DELIVERED TOTAL TO DUNDEE, OREGON** **\$ 6,450.00**

LEAD TIME: Shipment can occur within 30 days after our receipt of an acceptable order and final specifications.

This quotation is good for 30 days and subject to our confirmation thereafter.

Shipping packages are usually heavy and awkward and require mechanical handling to accomplish truck unloading at destination. Truck unloading and job site work are extra and not included.

To enter your order, simply notify us and we will promptly prepare a written order Confirmation to begin processing your order. Our standard terms of sale will apply.

If we may be of further assistance to you in any way, please contact our design headquarters by e-mail or at the telephone number shown above.

Best regards,

COLUMBIA CASCADE COMPANY

By: *Katherine Wilson*

Katherine Wilson  
kat@timberform.com

Visit our Web site [www.timberform.com](http://www.timberform.com)

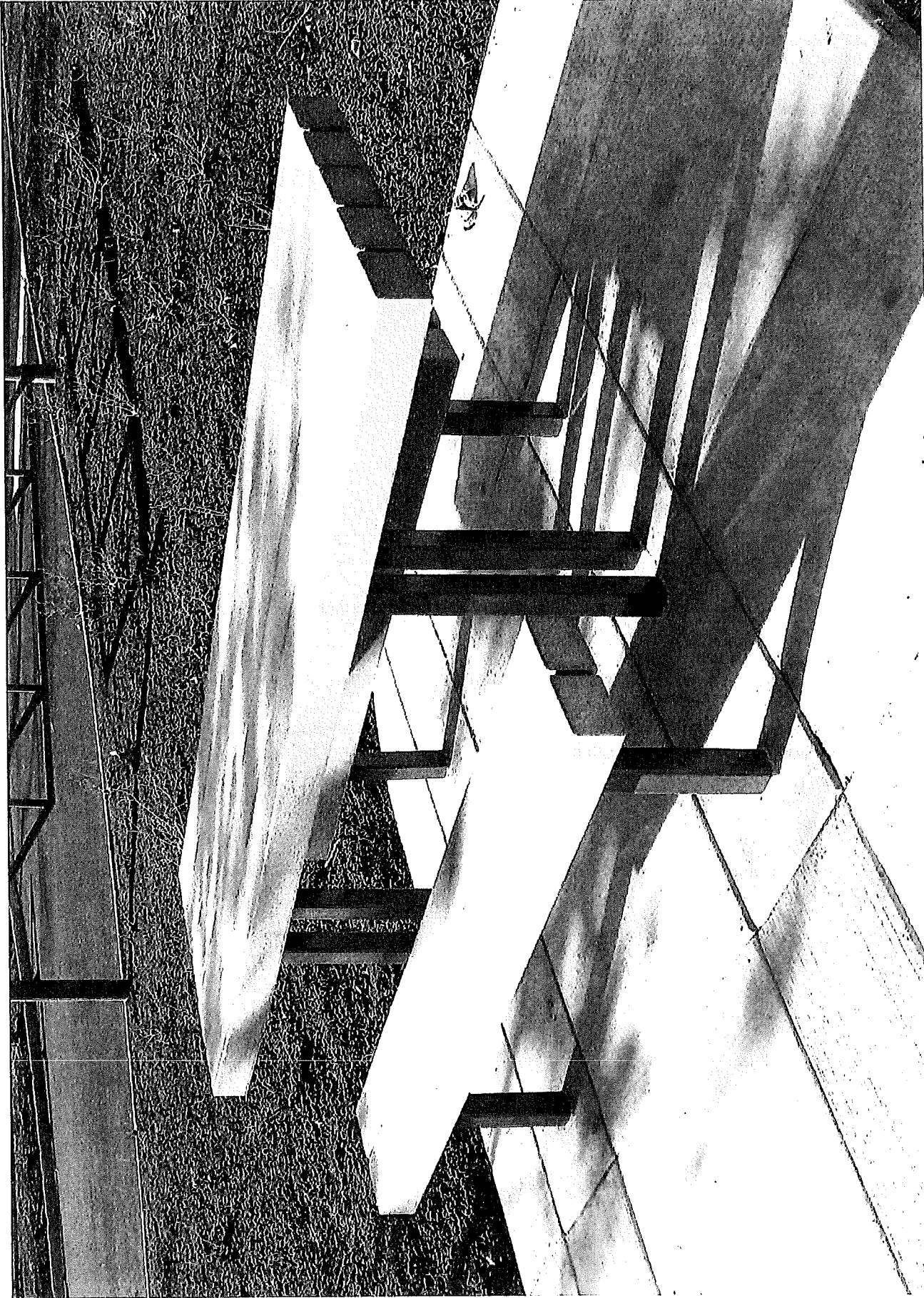

*Handwritten note:*  
M  
D  
P  
C  
K  
e